

**OPTION A: BANQUET STYLE**  
32 BANQUET TABLES; 320 CHAIRS

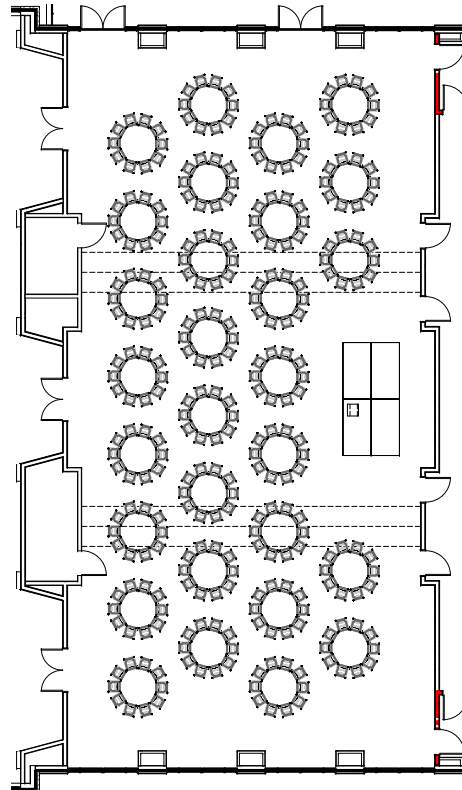

**OPTION B: BANQUET STYLE WITH STAGE**  
29 BANQUET TABLES; 290 CHAIRS

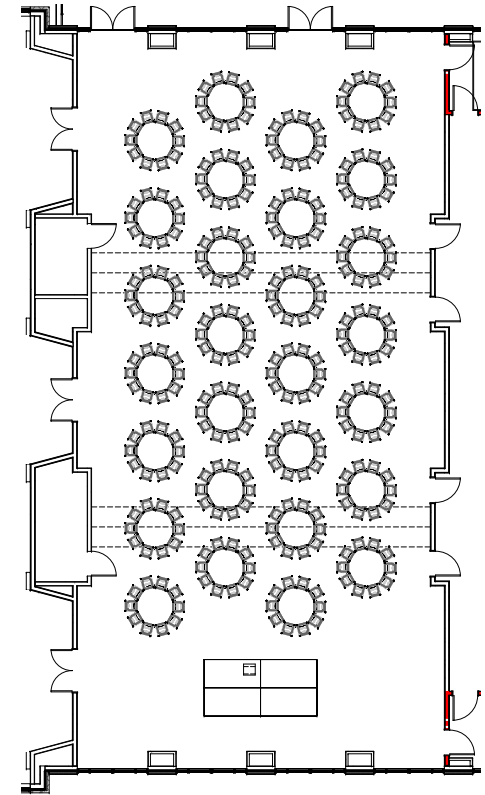

**OPTION C: BANQUET STYLE WITH STAGE**  
28 BANQUET TABLES; 280 CHAIRS

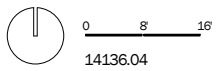

## BALLROOM LAYOUT OPTIONS

Texas Wesleyan University Martin Center

05/31/19

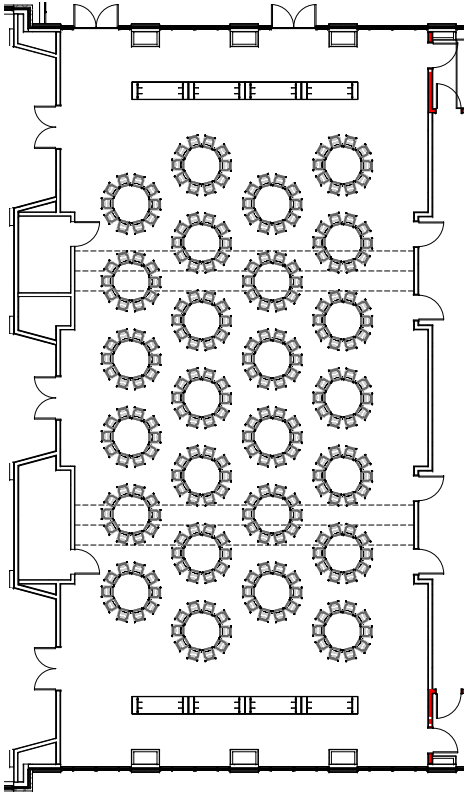

**OPTION D: BANQUET STYLE WITH BUFFET**  
26 BANQUET TABLES; 260 CHAIRS

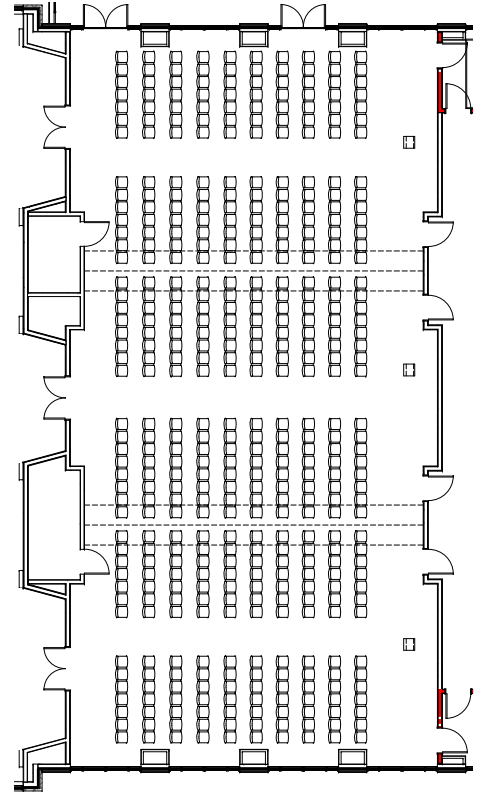

**OPTION E: LECTURE STYLE**  
440 TOTAL CHAIRS

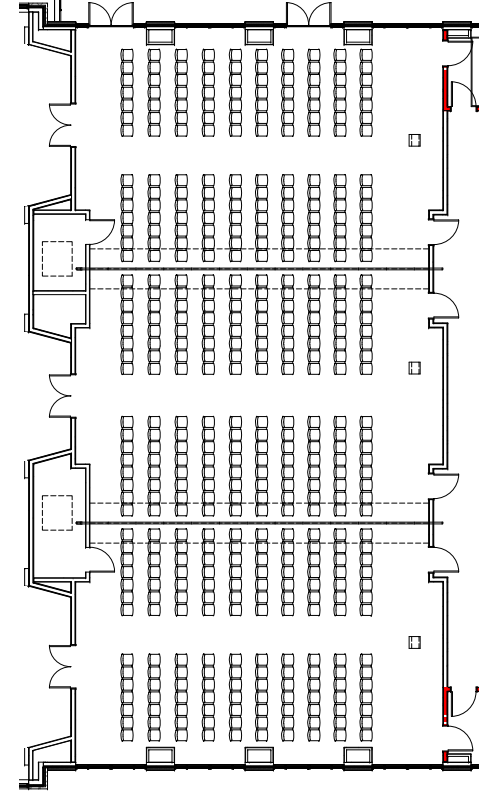

**OPTION F: LECTURE STYLE WITH PARTITIONS**  
NORTH BALLROOM: 140 CHAIRS  
CENTRAL BALLROOM: 160 CHAIRS  
SOUTH BALLROOM: 140 CHAIRS

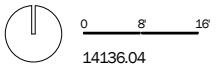

**BALLROOM LAYOUT OPTIONS**  
Texas Wesleyan University Martin Center

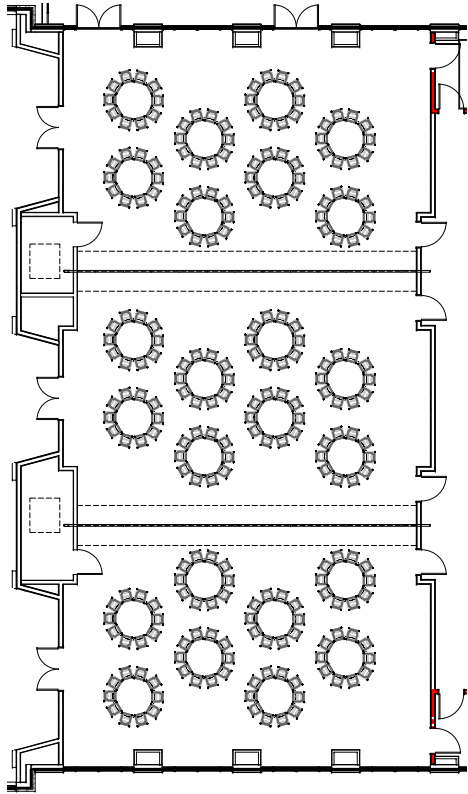

**OPTION G: BANQUET STYLE WITH PARTITIONS**  
EACH BALLROOM: 8 TABLES; 80 CHAIRS

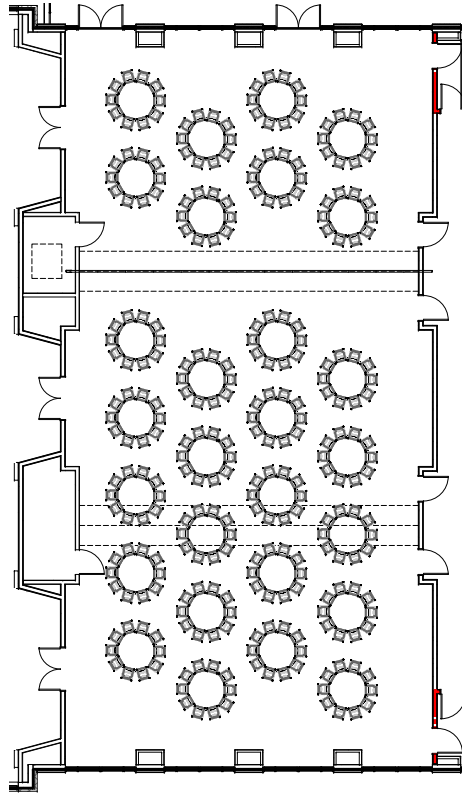

**OPTION H: BANQUET STYLE WITH ONE PARTITION**  
NORTH BALLROOM: 8 TABLES; 80 CHAIRS  
SOUTH BALLROOM: 20 TABLES; 200 CHAIRS

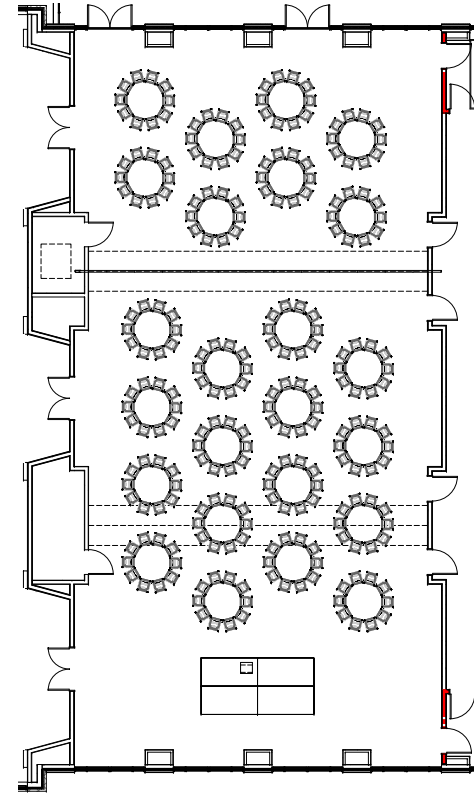

**OPTION I: STAGE WITH ONE PARTITION**  
NORTH BALLROOM: 8 TABLES; 80 CHAIRS  
SOUTH BALLROOM: 16 TABLES; 160 CHAIRS

05/31/19

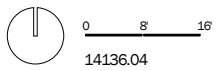

## BALLROOM LAYOUT OPTIONS

Texas Wesleyan University Martin Center

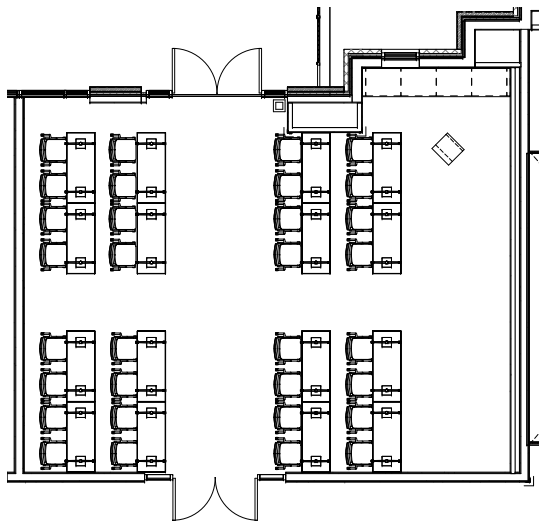

**OPTION A**  
16 TABLES; 32 CHAIRS

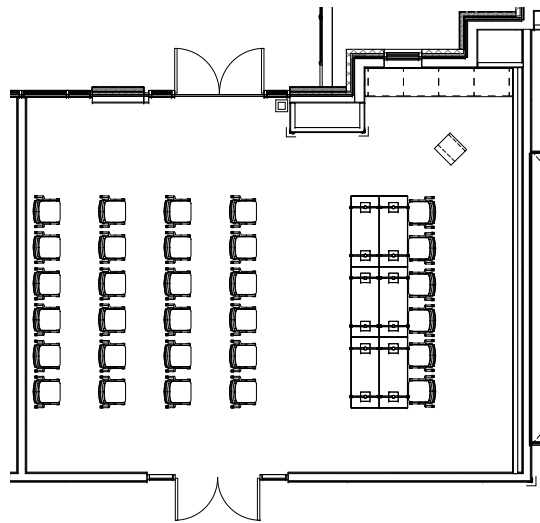

**OPTION B**  
6 TABLES; 30 CHAIRS

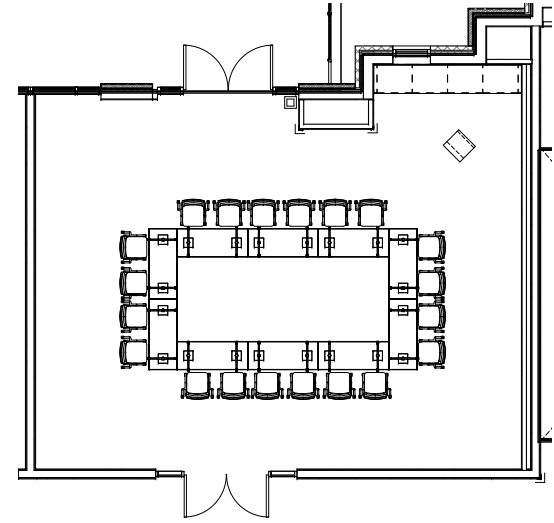

**OPTION C**  
10 TABLES; 20 CHAIRS

05/31/19

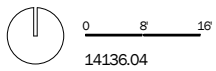

14136.04

## SGA BOARDROOM LAYOUT OPTIONS

Texas Wesleyan University Martin Center

**BENNETT • BENNER**  
**PARTNERS**  
ARCHITECTS • PLANNERS