

OPTION A: BANQUET STYLE
32 BANQUET TABLES; 320 CHAIRS

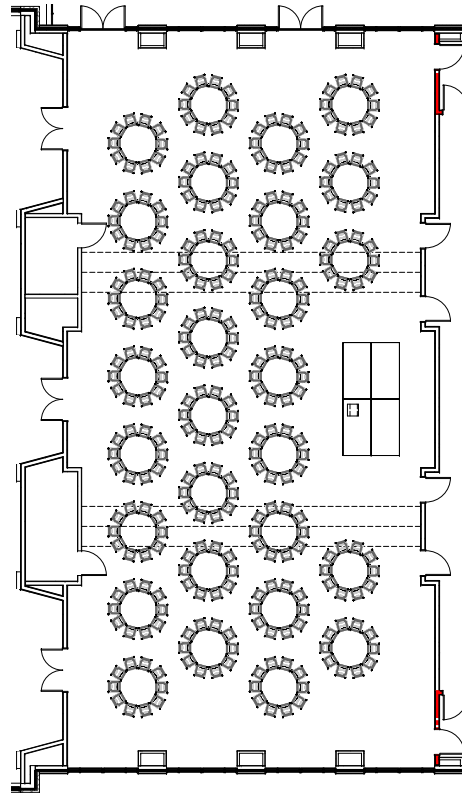

OPTION B: BANQUET STYLE WITH STAGE
29 BANQUET TABLES; 290 CHAIRS

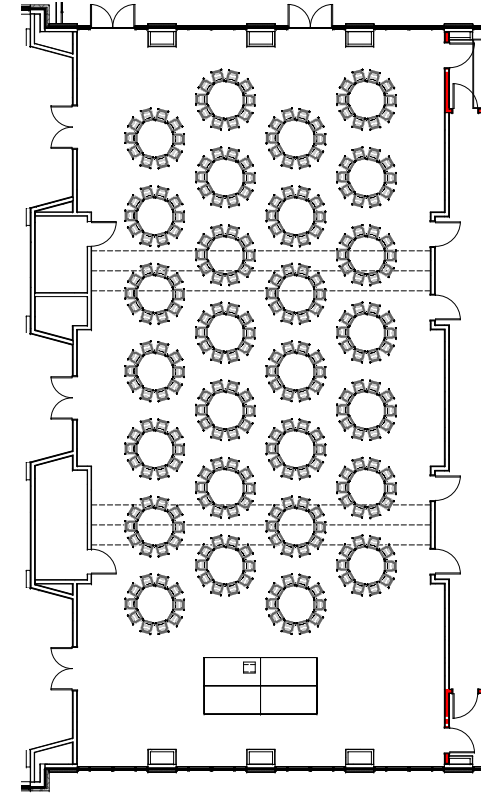

OPTION C: BANQUET STYLE WITH STAGE
28 BANQUET TABLES; 280 CHAIRS

05/31/19

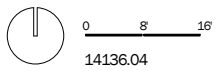

BALLROOM LAYOUT OPTIONS

Texas Wesleyan University Martin Center

BENNETT • BENNER
PARTNERS
ARCHITECTS • PLANNERS

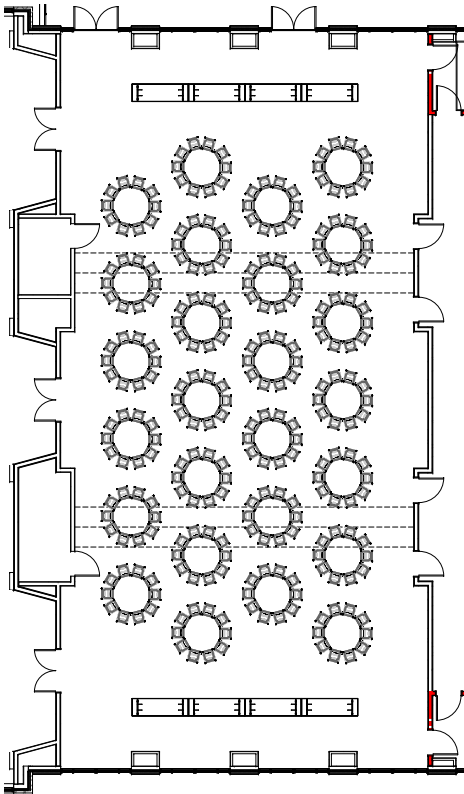

OPTION D: BANQUET STYLE WITH BUFFET
26 BANQUET TABLES; 260 CHAIRS

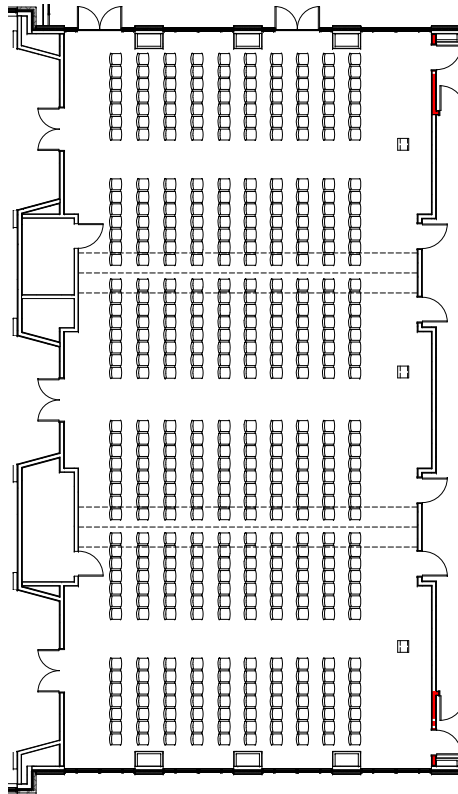

OPTION E: LECTURE STYLE
440 TOTAL CHAIRS

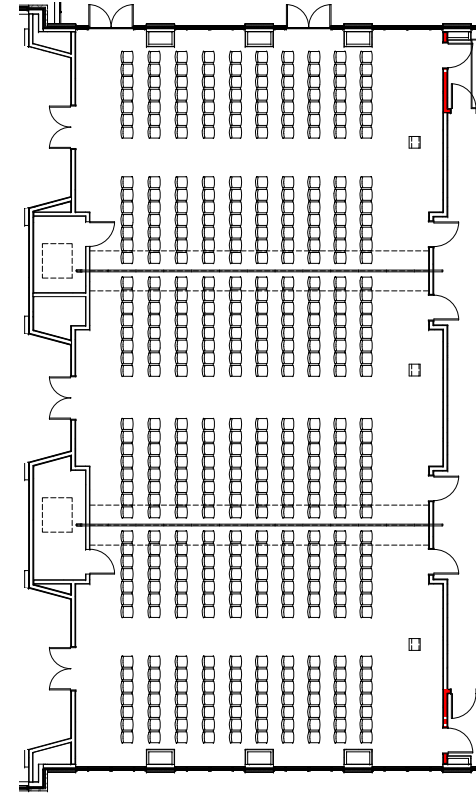

OPTION F: LECTURE STYLE WITH PARTITIONS
NORTH BALLROOM: 140 CHAIRS
CENTRAL BALLROOM: 160 CHAIRS
SOUTH BALLROOM: 140 CHAIRS

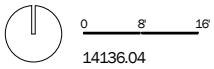

BALLROOM LAYOUT OPTIONS

Texas Wesleyan University Martin Center

05/31/19

BENNETT • BENNER
PARTNERS
ARCHITECTS • PLANNERS

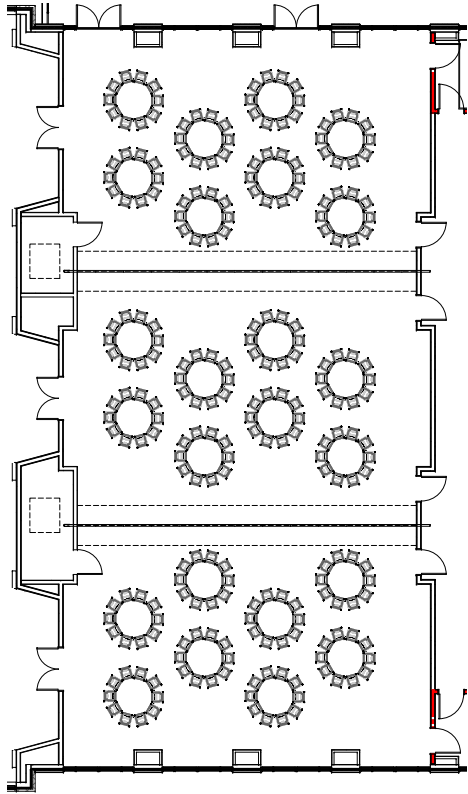

OPTION G: BANQUET STYLE WITH PARTITIONS
EACH BALLROOM: 8 TABLES; 80 CHAIRS

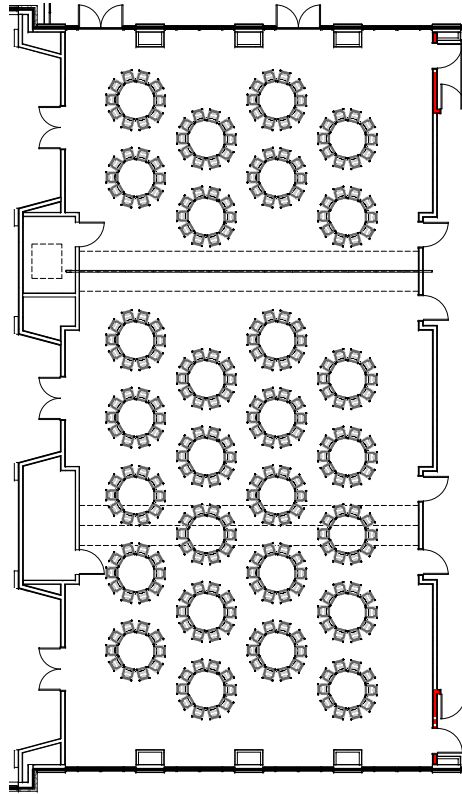

OPTION H: BANQUET STYLE WITH ONE PARTITION
NORTH BALLROOM: 8 TABLES; 80 CHAIRS
SOUTH BALLROOM: 20 TABLES; 200 CHAIRS

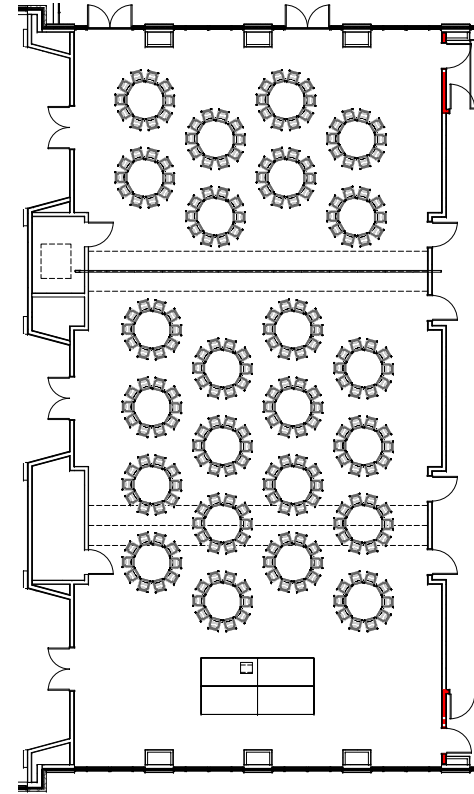

OPTION I: STAGE WITH ONE PARTITION
NORTH BALLROOM: 8 TABLES; 80 CHAIRS
SOUTH BALLROOM: 16 TABLES; 160 CHAIRS

05/31/19

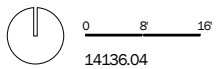

BALLROOM LAYOUT OPTIONS

Texas Wesleyan University Martin Center

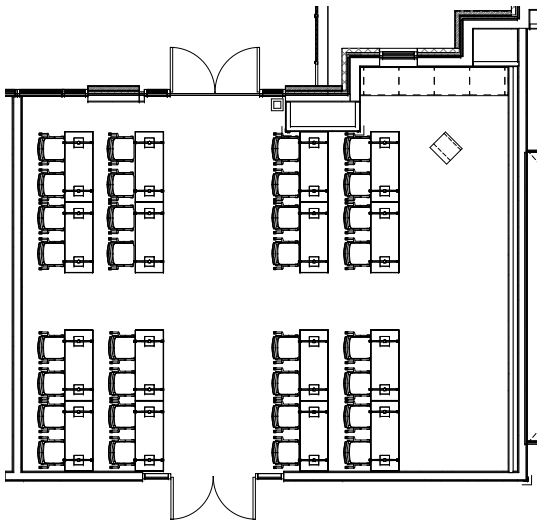

OPTION A
16 TABLES; 32 CHAIRS

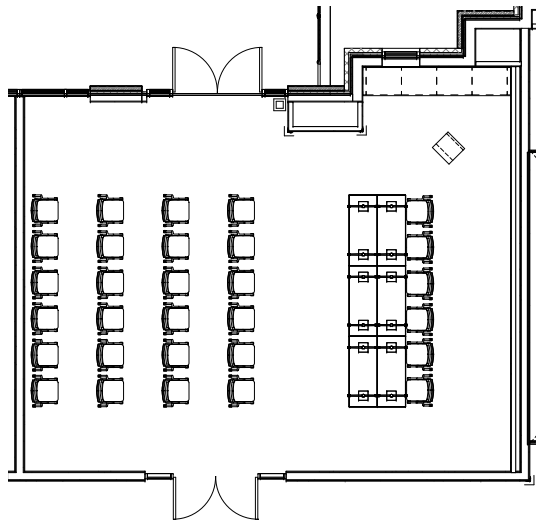

OPTION B
6 TABLES; 30 CHAIRS

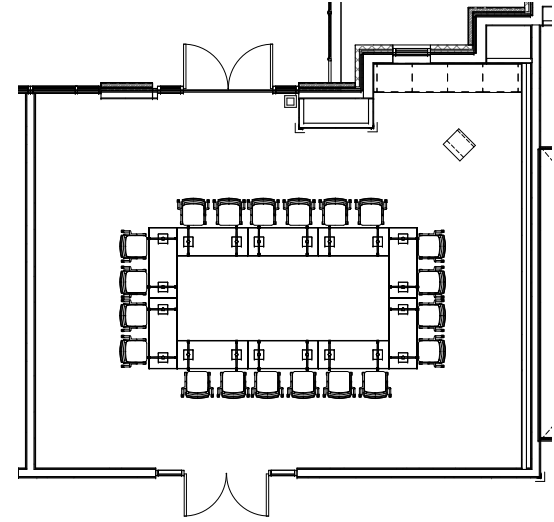

OPTION C
10 TABLES; 20 CHAIRS

05/31/19

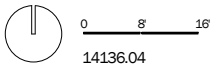

SGA BOARDROOM LAYOUT OPTIONS

Texas Wesleyan University Martin Center

BENNETT • BENNER
PARTNERS
ARCHITECTS • PLANNERS